

Date Submitted _____

No. 15608

APPLICATION FOR BUILDING

The undersigned hereby applies for a permit to build, in accordance with the information tabulated hereafter,

Type of Project RESIDENCE Address 1015 E CHURCHILL LANE
Residence, Garage, Store, Office, School, Fence, Shed, Sign, Swimming Pool, Underground Storage Tank, Etc.

Lot _____ Block _____ Subdivision _____ District _____

Does contemplated structure violate the Village zoning ordinance? _____

Height of Structure _____ (stories or feet)

Width (parallel to highway) _____ (feet) Depth (perpendicular to highway) _____ (feet)

Distance: Street Line to Front Line of Structure _____ (feet)

Distance: Side Lot Line to Structure _____

Type of Construction: _____ Exterior finish _____
Frame, Brick-tile, etc. Stucco, Siding, Brick Veneer, Etc.

Height of front yard above street grade _____

Number of rooms _____ Baths _____

Garage _____

Estimated cost Building \$15,868⁰⁰

Structure _____

Is there a private garage? _____

Does the contemplated garage violate the Village zoning ordinance? _____

Size _____ Number of Stalls _____ Where Situated _____

Have plans been submitted to the Wisconsin Department of Industry, Labor and Human Relations for examination and approval? _____

Have plans been approved as being in compliance with all applicable sections of the Wisconsin Administrative code? _____

Herewith are filed the following duplicate plans _____ in number, which I certify I will conform to in the work

hereby applied for:

Remarks: REMOVE OLD ROOF DOWN TO DECK, NEW LINENS, FLASHING, VENTS, APPLY DIMENSIONAL SHINGLES (BLACK) SAME COLOR AS NEW

Herewith are filed the specifications that describe the work in question and as shown on plans above submitted.

In making the application the undersigned agrees to obey the Fox Point Building and Zoning Codes pertaining to the erection of all structures and also agrees to obey all other ordinances of the Village of Fox Point.

The undersigned, owner or being duly authorized so to do, hereby gives express authorization to the Village of Fox Point, its officers, agents and employees, to enter upon the premises herein described and fill up any excavation, or tear down, remove or enclose the unfinished structure for which a permit is herein requested in the event of cessation of the building, whenever the Building Inspector shall determine that such premises in the unfinished condition of the structure are dangerous to members of the public, including children, even though trespassers. The undersigned further hereby waives all statutory notices and consents to the determination by the Village Board and the levy and placing upon the tax roll of a special assessment in the amount of the cost to the Village, including customary Village overhead charges incurred in filling up any such excavation or tearing down, removing or enclosing any such unfinished structure.

We hereby agree to provide a house number plate or sign readily observable from the public highway which will be installed not less than 15 days after the structure is occupied.

Owner of Structure GARY TAXMAN Arch. or Contr. STANDARD ROOFING CO. INC

Address 1015 E CHURCHILL LANE Address 1820 SO. F.M. AVE

City FOX POINT State WIS Zip 53217 City MILWAUKEE State WIS Zip 5

Phone 414-217-8678 Phone 414-384-8828

Size of Structure _____ (sq. ft.) Permit Fee \$151⁻ Receipt 45489 11/13/13

Dwelling Contractor Certification No. 7095 Expires 8/15/14

Dwelling Contractor Qualifier Certification No. 7096 Expires 9/21/15

Building Contractor Certification No. _____ Applicant Signature Gary Taxman

Date of Approved 11/12/13 Architect, Owner, Builder

Builder Inspector

ID: 7095

STANDARD ROOFING CO INC

Certification, License, or Registration Name

Dwelling Contractor Certification

Expires

08/15/14

Wisconsin Department of Safety and Professional Services

Signature: *Dary C Freuden*

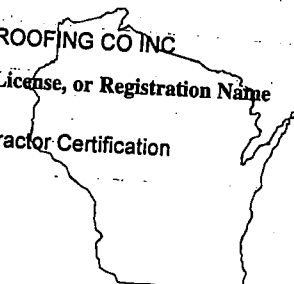

ID: 7096

GARY CARL FREUDEN

Certification, License, or Registration Name

Dwelling Contractor Qualifier Certification

Expires

09/21/15

Wisconsin Department of Safety and Professional Services

Signature: *Dary C Freuden*

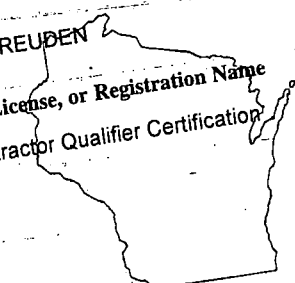

min Fee \$ 50.00

Receipt # 31717

APPLICATION AND RECORD FOR HEATING PERMIT

TO THE BUILDING INSPECTION DEPARTMENT:

The undersigned hereby applies for a permit to install, in accordance with the information tabulated hereafter,

Winter Air Conditioner Type Forced Air
Forced Air, Radiant, Baseboard, Etc.

Fuel: Gas Oil Coal Elect. Other _____

Desc. of Heating Plant Forced Air Gas Furnace Replacement
120,000 BTU TRANE

Vented to outside

Fuel Tank : _____
Size _____ Location _____

Summer Air Conditioner Size _____ (Ton, H.P.)

Coolant _____

Compressor Coolant: Air ; Water ;

If Water Cooled:
Source of Water _____

Discharged to _____

Location of unit on premises including distances to lot lines required for approval of exterior apparatus.

Incinerator Manufacturer's Name _____

Model No. _____ Capacity _____ Bushels

Has installation permit been issued by Milwaukee Co. Dept. of Air Pollution Control? _____

Remarks _____

The undersigned acknowledges that he is familiar with Ordinance No. 261, and all amendments thereto and that the work described herewith shall conform in all respects to said ordinances and all other ordinances of the Village of Fox Point, and laws of the State of Wisconsin. Any variations of the above may cause immediate revocation of the permit, if granted.

Owner GARY TAXMAN

Address of Work 1015 E. Churchill Lane

OFFICE USE ONLY
Application Approved: [Signature]
Installation Approved: _____

[Signature]
Signed _____
2-11-10
Date _____

Contractor TOTAL MECHANICAL

Address W234 N2830 PAUL RD Phone 262-523-2500

City PEWAUKEE State WI Zip 53072

State Credential Number 5893 & Expiration Date 3-5-10



Credential Search Menu

Search for Individual or Company by Credential ID here:	
Specific Credential ID	<input type="text" value="5893"/>
<input type="button" value="Search"/>	

Find Company OR Individual 2 record(s) were returned by your search.
 Black=Approved Blue=In Renewal Process Red=Expired or Not Valid

- [Search by Credential ID](#)
- [Advanced Search](#)

ID	Name	City,State,Zip	Credential Type	Expiration
5893	TOTAL MECHANICAL INC,	PEWAUKEE WI 53072-5731	Electrical Contractor	06/30/12
5893	TOTAL MECHANICAL INC,	PEWAUKEE WI 53072-5731	HVAC Contractor	03/05/10

Find Tank Contractor

- [Search by Tank Specialty](#)

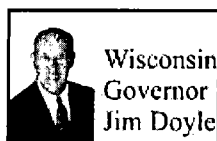



[Back to the top](#) | [Privacy Statement](#) | [Legal Notices, Disclaimers, and Terms of Use](#)
[Web site comments](#) | [Browser support](#)

Receipt No: 1.031717

Feb 23, 2010

•
1015 E CHURCHILL

LICENSES & PERMITS-ELECTRICAL PERMIT 50.00
24-44430 ELECTRICAL PERMIT

1015 E CHURCHILL LANE

LICENSES & PERMITS-HEATING PERMIT 50.00
24-44450 HEATING PERMIT

Total: 100.00

CHECK Chk No: 124009 100.00
Total Applied: 100.00

Change Tendered: .00

Duplicate Copy

02/23/10 09:01am

VILLAGE OF FOX POINT

7200 N. SANTA MONICA BLVD.
FOX POINT 53217
414-351-8900

OFFICE USE ONLY	
Permit No.	19306
Received	2/23/10
Service	
Rough-In	
Final	

APPLICATION FOR ELECTRICAL PERMIT

Date 2/10/10
License No. 29

PLEASE TYPE OR PRINT WITH BALL POINT PEN

Builder	Owner <u>Gary Taxman</u>	Occupant
---------	-----------------------------	----------

Job Address 1015 E. Churchill Lane, Fox Point WI 53217

ESTIMATED COST OF JOB 200-

- Buildings Residential
 Commercial
 Industrial
 Institutional
 New Construction
 Additional Rooms
 Remodeling
 New Occupancy

Where on Premises?

Describe Basement
wire replacement furnace

List Name of Installing Contractor

HEATING TOTAL Mechanical
AIR CONDITIONING _____
PLUMBING _____

Date of Inspection	
Rough _____	Will Call <input type="checkbox"/>
Final _____	Will Call <input type="checkbox"/>
Service Approval Sent _____	<input type="checkbox"/>

REMARKS:

No.	Description	Qty.	Rate of Fees	Dollars	Cents
1	Light, switch and convenience outlets		.35 ea		
2	Lighting Fixtures		.30 ea		
3	Fluorescent Fixtures - per tube		.30 ea		
4	Range, Electric		4.00 ea		
5	Garbage Grinding and Disposal Unit		3.00 ea		
6	Dishwasher		4.00 ea		
7	Clothes Dryer		4.00 ea		
8	Water Heaters, Electric		4.00 ea		
9	Gas Burner, Oil Burner or Stoker	1	5.00 ea	5	00
10	Refrigerating, Air Cooling or similar machine - .25 per HP		5.00 min		
11	Feeders - No. 6 A.W.G. or Larger		7.00 ea		
12	Temporary Service Permit for: How Long?		10.00 ea		
13	Services: Service Switches, ea.		5.00 ea		
	Service 1. 0 through 100 amps.		5.00 ea		
	2. 101 through 400 amps.		10.00 ea		
	3. 401 through 600 amps.		10.00 ea		
	4. 601 through 1000 amps.		15.00 ea		
	5. Thereafter, ea. additional 1000 amps.		5.00 ea		
14	Motors over 1/4 HP		.30 per HP or frac		
15	Fuel Dispensing Pumps		6.00 ea		
16	Transformers, Rectifiers and Generators		.30 per KW		
17	Space Heating Systems, per circuit		3.00 ea		
18	Power receptacles - 120 Volts or over 1. Through 30 amps		3.00 ea		
19	2. Over 30 amps		5.00 ea		
20	Wireways, busways, underfloor raceways or auxillary gutters		.25 per ft		
21	Strip Lighting, Plug-in Strip, Trol-E Duct or similar system		.20 per ft		
22	Signs, Electric - .10 ea. socket, plus .50 ea. add'l. transformer		8.00 min		
23	Swimming Pool Wiring: A. Inground pools		40.00		
24	B. Above ground pools		25.00		
25	Spas, Hot-tubs, Hydromassage Bathtubs		6.00		
26	MINIMUM CHARGE FOR ANY ONE PERMIT		50.00 ea	50	-
27	FAILURE TO CALL FOR FINAL INSPECTION		15.00		
28	DOUBLE FEES will be charged for any work started before obtaining permit.				

Receipt #31717

TOTAL FEES	50 -
------------	------

The undersigned hereby makes application for a permit for the execution of electrical installation for light, heat or power as prescribed and agrees to comply with all applicable State and Local Codes and Ordinances regulating the installation of electrical wiring and equipment in the Village of Fox Point.

MAKE CHECKS PAYABLE TO:
Treasurer, Village of Fox Point
MAIL TO: Electrical Inspector

Contractor <u>TOTAL Mechanical</u>	Supervising Electrician (Signature) <u>[Signature]</u>	Date <u>2-10-10</u>
Address <u>W234 N2030 Paul Rd</u>	Telephone <u>414-397-8442</u>	
City <u>Pewaukee</u>	State <u>WI</u>	Zip Code <u>53072</u>

This Permit is void if work is not started within 2 months, or if started, no work is done for 2 months.

Receipt No: 1031717

Feb 23, 2010

1015 E CHURCHILL

LICENSES & PERMITS-ELECTRICAL PERMIT 50.00
24-44430 ELECTRICAL PERMIT
1015 E CHURCHILL LANE

LICENSES & PERMITS-HEATING PERMIT 50.00
24-44450 HEATING PERMIT

Total: 100.00

CHECK Chk No: 124009 100.00
Total Applied: 100.00

Change Tendered: .00

02/23/10 09:01am

24676R

#40 - Receipt #33538

VILLAGE OF FOX POINT
MILWAUKEE COUNTY, WISCONSIN

No. 5677C

APPLICATION AND RECORD FOR HEATING PERMIT

TO THE BUILDING INSPECTION DEPARTMENT:

The undersigned hereby applies for a permit to install, in accordance with the information tabulated hereafter,

Winter Air Conditioner Type Forced Air
Forced Air, Radiant, Baseboard, Etc.

Fuel: Gas Oil Coal Elect. Other

Desc. of Heating Plant Carrier, MN# 58SXA120-LG, 120,000 BTU

Vented to West side of house

Fuel Tank : _____
Size Location

Summer Air Conditioner Size 4 ton (Ton, H.P.)

Coolant R-22

Compressor Coolant: Air ; Water ;

If Water Cooled:
Source of Water _____

Discharged to _____

Location of unit on premises including distances to lot lines required for approval of exterior apparatus.
West side of house

Incinerator Manufacturer's Name _____

Model No. _____ Capacity _____ Bushels

Has installation permit been issued by Milwaukee Co. Dept. of Air Pollution Control? _____

Remarks _____

The undersigned acknowledges that he is familiar with Ordinance No. 261, and all amendments thereto and that the work described herewith shall conform in all respects to said ordinances and all other ordinances of the Village of Fox Point, and laws of the State of Wisconsin. Any variations of the above may cause immediate revocation of the permit, if granted.

Owner Gary Taxman

Address of Work 1015 1/2 Churchill Lane, Fox Point

OFFICE USE ONLY	
Application Approved: <u>[Signature]</u> 5/16/00	Installation Approved: _____

Belinda J. Cone
Signed
5-5-00
Date

Contractor Total Comfort of Wisconsin, Inc.

Address W234 W2830 Paul Rd. Phone (262) 523-2500

City Pewaukee State WI Zip Code 53072

\$40.00

APPLICATION FOR BUILDING PERMIT

TO THE BUILDING INSPECTION DEPARTMENT:

The undersigned hereby applies for a permit to build, in accordance with the information tabulated hereafter,

Type of Structure FENCE WITH GATES (2)
Residence, Garage, Store, Office, School, Fence, Shed, Sign, Swimming Pool, Etc.

Address 1015 E. CHURCHILL LN.

Lot THREE Block TWO

Subdivision FOX POINT

District _____

Does contemplated structure violate the Village zoning ordinance? NO

Height of Structure Six feet on W., 4 feet on E. (stories or feet)

Width (parallel to highway) Twelve (W), 18 (E) (feet) Depth (perpendicular to highway) 57 (W), 33 (E) (feet)

Distance: Street Line to Front Line of Structure NINETY NINE (W), 80 (E) (feet)

Distance: Side Lot Line to Structure ± ONE FOOT (W) ± ONE FOOT (E)

Type of Construction: FRAME Exterior finish CEDAR - LATTICE TOP
Frame, Brick-tile, Etc. Stucco, Siding, Brick Veneer, Etc.

Height of front yard above street grade _____

Number of rooms _____ Baths _____

Garage _____

Estimated cost Building _____

Structure \$ 2,500.00

Is there a private garage? _____

Does the contemplated garage violate the Village zoning ordinance? _____

Size _____ Number of stalls _____

Where situated _____

General construction _____
Frame - Brick - Stucco - Etc.

Have plans been submitted to the Wisconsin Department of Industry, Labor and Human Relations for examination and approval? _____

Have plans been approved as being in compliance with all applicable sections of the Wisconsin Administrative code? _____

Herewith are filed the following duplicate plans _____ in number, which I certify I will conform to in the work hereby applied for.

Remarks: SEE ATTACHED SKETCH.

Herewith are filed the specifications that describe the work in question and as shown on plans above submitted.

In making the application the undersigned agrees to obey the Fox Point Building and Zoning Codes pertaining to the erection of all structures and also agrees to obey all other ordinances of the Village of Fox Point.

The undersigned, owner or being duly authorized so to do, hereby gives express authorization to the Village of Fox Point, its officers, agents and employees, to enter upon the premises herein described and fill up any excavation, or tear down, remove or enclose the unfinished structure for which a permit is herein requested in the event of cessation of the building, whenever the Building Inspector shall determine that such premises in the unfinished condition of the structure are dangerous to members of the public, including children, even though trespassers. The undersigned further hereby waives all statutory notices and consents to the determination by the Village Board and the levy and placing upon the tax roll of a special assessment in the amount of the cost to the Village, including customary Village overhead charges incurred in filling up any such excavation or tearing down, removing or enclosing any such unfinished structure.

We hereby agree to provide a house number plate or sign readily observable from the public highway which will be installed not less than 15 days after the structure is occupied.

Owner of Structure Gary and Marci Taxman Arch. or Contr. A-1 FENCE CO., INC.

Address 1015 E. CHURCHILL LN. Address 11040 N. BUNTROCK AVE.

City FOX POINT WI 53217 City MEQUON, WI 53092
State Zip State Zip

Phone 351-0027 Phone 251-6706

Size of Structure _____ (sq. ft.) Permit Fee 40.00 Receipt # 12439 herewith tendered

Date Submitted 5-27-97

Date Approved 6-3-97 Suzanne E. Jye Signed _____

Date of Permit _____
Architect, Owner, Builder

All Applications MUST INCLUDE THE
Following INFORMATION:

(2.) APPLICATION FOR PERMITS -- Application for a building permit shall be made in writing upon a blank form to be furnished by the Building Inspector and shall state the name and address of the owner of the building and the owner of the land on which it is to be erected, the name and address of the designer and shall set forth a legal description of the land on which the building is to be located, the location of the building, the house number thereof and such other information as the Building Inspector may require. With such application, there shall be submitted, to the Building Inspector, three (3) complete sets of plans, specifications and three (3) copies of a survey.

(a.) Survey -- The survey shall be prepared and certified by a surveyor or registered by the State of Wisconsin; shall be made, in no case, prior to one (1) year prior to the issuance of a building permit; and shall bear the date of the survey. The certified survey shall also show the following:

1. Location and dimensions of all buildings on the lot, both existing and proposed.
2. Dimensions of the lot.
3. Dimensions showing all setbacks to all buildings on the lot.
4. Proposed grade of proposed structure, to city or village datum.
5. Grade of lot and of road opposite lot.
6. Grade and setback of adjacent buildings. If adjacent lot is vacant, submit elevation of nearest buildings on same side of the road.
7. Type of monuments at each corner of lot.
8. Water courses or existing drainage ditches.
9. Seal and signature of surveyor.

(b.) Plans and Specifications -- All plans shall be drawn to a scale not less than one-fourth (1/4) inch per foot, on paper or cloth in ink, or by some other process that will not fade or obliterate, and shall disclose the existing and proposed provisions for water supply, sanitary sewer connections and surface water drainage. All dimensions shall be accurately figured. Drawings that do not show all necessary detail shall be rejected.

A complete set of plans for residential construction shall consist of:

1. All elevations.
2. All floor plans.
3. Complete construction details.
4. Fireplace details (3/4 inch per foot) showing cross section of fireplace and flues.
5. Plans of garage when garage is to be built immediately or location of garage when it is to be built at a later date.

All plans shall remain on file in the office of the Building Inspector until at least one (1) year after the completion of the building, after which time the Building Inspector may return the same to the owner, may keep them for public record or may destroy them.

- (3.) WAIVER OF SOME REQUIREMENTS -- At the option of the Building Inspector, plans, data, specifications and survey need not be submitted with an application for permit to execute minor alterations and repairs to any building, structure or equipment, provided the proposed construction is sufficiently described in the application for permit.
- (4.) SEAL OF REGISTERED ENGINEER OR ARCHITECT -- All plans, data and specifications for the construction of any building or structure or for any construction in connection with existing buildings or structures, other than one and two family residences containing more than fifty thousand (50,000) cubic feet, total volume, submitted with an application for permit, shall bear the seal of the registered architect or engineer. The plans shall also be stamped as approved as required by the Department of Industry, Labor and Human Relations of the State of Wisconsin. Such building or structure shall be constructed under the supervision of an architect or engineer who shall be responsible for its erection in accordance with the approved plans. No permit shall be granted for such structure unless such construction will be under the supervision of an architect or engineer, as required by the Wisconsin Statutes. A written statement to this effect shall be filed by the architect or engineer, with the Building Inspector, with the application for permit.
- (5.) DRAINAGE
- (a.) Grading of lots -- The plans shall show the present and proposed grades of the lot on which it is proposed to erect the building for which a building permit is sought and of the immediately adjoining property in sufficient detail to indicate the surface water drainage before and after the completion of the grading. No permit shall be issued if the erection of the building and the proposed grades shall unreasonably obstruct the natural flow of water from the surface of adjoining property or obstruct the flow of any existing ravine, ditch, drain or storm water sewer draining neighboring property, unless suitable provision is made for such flow by means of an adequate ditch or pipe, which shall be shown on the plans and shall be constructed so as to provide continuous drainage at all times.



VILLAGE OF FOX POINT

MILWAUKEE COUNTY

WISCONSIN

VILLAGE HALL
7200 N. SANTA MONICA BLVD
FOX POINT 53217-3505
414-351-8900

From: The Fox Point Building Inspector

RE: Notice of Proposed Fence Construction

Please have your abutting neighbors complete this form when proposing to build a fence more than 3 1/2 feet in height in either your sideyard or front yard.

I have read the application for a fence permit. This fence will be constructed at E. and W. Sideyard at 1015 E. CHURCHILL

Neighbor Number 1

Neighbor's Name: Tim Nettlesheim
Neighbor's Address: 999 E. CHURCHILL
Neighbor's Signature: [Signature]
Date: 5/25/97

Neighbor Number 2

Neighbor's Name: Mrs. W.C. Johnson
Neighbor's Address: 8119 N. Lake Dr.
Neighbor's Signature: _____
Date: 5-25-97

Neighbor Number 3

Neighbor's Name: _____
Neighbor's Address: _____
Neighbor's Signature: _____
Date: _____

E. CHURCHILL LANE

(60' R.O.W.)

LOT 4, BLK 2

0.9' CLEAR

N 00° 05' W

30'

N 89° 55' E

92.57'

29.4'

BRICK STOOP

131'

BRICK DWELLING

14.0' WITH C.S. ROOF

BRICK PATIO

WOOD FENCE

- 6 FOOT, without gate

replace existing fence w/6' lattice top and gate on N., 29 feet of solid panel meeting lattice top for balance of fence.

LOT 3, BLK 2

(FOX POINT SUBDIVISION)

ASPHALT DRIVE

30'

9.6'

3' gate

4' lattice top fence

33

S 00° 05' E

185.41'

185.41'

KEY:

Bedroom, bath addition in 1994

NEW fence, gate

NOTE

6' WIDE UTILITY EASEMENT

92.57'

S 89° 55' W

Plumber Wm Zachow
 Address 5718 W Hemlock
 Tel. No. 358 2137

No. 74840
Application and Record
 Village of Fox Point
 7200 N. Santa Monica Blvd.
 Fox Point, WI 53217
 351-8900

Owner Gary Taxman
 Address 1015 E Chyckill
 Date Oct 18, 1993

TO the VILLAGE OF FOX POINT, PLUMBING AND WATER INSPECTION DEPARTMENT: The undersigned hereby makes application to do the work of plumbing consisting of

laying a inch laying a inch
 builder sewer from Main to Lot line water service from Main to Lot line
 to Building to Building
 at

PERMITS USED	
Kind	No.
Sewer and Plumbing	<u>4198</u>
Water	
Street	
Meter	
Water Usage	

1015 E Chyckill Fox Point, Wis.
 Address at which work is to be done

Subdivision	Lot	Block

In the performance of this work the undersigned Plumber hereby agrees to be bound by and submit to all statutes, village ordinances, and rules and regulations prescribed by the Village Board for Plumbers.

License No. 3947 Wm Zachow Plumber

Application must be signed by licensed plumber who has current insurance certificate on file in Fox Point.

FIXTURES WITH DRAIN OR WATER CONNECTIONS

No.	No.
Hose Bibs	Dishwashers
Bath Tube	Wash Basins
Sump Pumps	Water Closets
Laundry Trays	Showers
Drinking Fountains	Floor Drains
Sinks	Food Waste Grinders
Water Heaters	Sprinkling System
Wash. Mach. Wastes	Urinals
Bidets	
Catch Basins	

FEES

Water Usage
Building Sewer
Water Service
Building Drain
Fixtures
Water Meter
Total	<u>\$40.00</u>
Deposit to cover street repairs	<u>Receipt #33249</u>

Seth Permit Clerk

A inch water service pipes laid in
 Curb box is located feet of feet of
 inch Water Meter No. Date Installed

A inch sanitary sewer connection was made in
 feet of manhole

A inch storm sewer connection was made in
 feet of manhole

Building Sewer	Report	Building Drain	Report	Rough In Plumbing Inspection	Report	Final Inspection	Report

Installation Approved Application Approved 10

As Built Water and Plumbing Inspector

REMARKS	DISCREPANCY RECORD

VILLAGE OF FOX POINT

7200 N. SANTA MONICA BLVD.
FOX POINT 53217
414-351-8900

OFFICE USE ONLY	
Permit No.	13430 ^C
Received	11/1/93
Service	
Rough-in	
Final	

APPLICATION FOR ELECTRICAL PERMIT

Date 10-18-93

License No. 74
B2 E

PLEASE TYPE OR PRINT WITH BALL POINT PEN

Builder <u>B2E CONTRACTORS</u>	Owner <u>GARY TAXMAN</u>	Occupant <u>GARY TAXMAN</u>
Job Address <u>1015 CHURCHIL</u>		

ESTIMATED COST OF JOB

- Buildings Residential
 Commercial
 Industrial
 Institutional
 New Construction
 Additional Rooms
 Remodeling
 New Occupancy

Where on Premises?
Describe NEW ADDITION
SOUTH SIDE OF
BLDH

List Name of Installing Contractor
HEATING
AIR CONDITIONING
PLUMBING

Date of Inspection	
Rough _____	Will Call <input type="checkbox"/>
Final _____	Will Call <input checked="" type="checkbox"/>
Service Approval Sent _____	<input type="checkbox"/>

REMARKS:

Left cans for final
11/1/93

No.	Description	Qty.	Rate of Fees	Dollars	Cents
1	Light, switch and convenience outlets	50	.35 ea	17	50
2	Lighting Fixtures	20	.30 ea	6	—
3	Fluorescent Fixtures - per tube		.30 ea		
4	Range, Electric		4.00 ea		
5	Garbage Grinding and Disposal Unit		3.00 ea		
6	Dishwasher		4.00 ea		
7	Clothes Dryer		4.00 ea		
8	Water Heaters, Electric		4.00 ea		
9	Gas Burner, Oil Burner or Stoker		5.00 ea		
10	Refrigerating, Air Cooling or similar machine - .25 per HP		5.00 min		
11	Feeders - No. 6 A.W.G. or Larger		7.00 ea		
12	Temporary Service Permit for: How Long?		10.00 ea		
13	Services: Service Switches, ea.		5.00 ea		
	Service 1. 0 through 100 amps.		5.00 ea		
	2. 101 through 400 amps.		10.00 ea		
	3. 401 through 600 amps.		10.00 ea		
	4. 601 through 1000 amps.		15.00 ea		
	5. Thereafter, ea. additional 1000 amps.		5.00 ea		
14	Motors over 1/4 HP		.30 per HP or frac		
15	Fuel Dispensing Pumps		6.00 ea		
16	Transformers, Rectifiers and Generators		.30 per KW		
17	Space Heating Systems, per circuit	1	3.00 ea	3	
18	Power receptacles - 120 Volts or over 1. Through 30 amps		3.00 ea		
19	2. Over 30 amps		5.00 ea		
20	Wireways, busways, underfloor raceways or auxillary gutters		.25 per ft		
21	Strip Lighting, Plug-in Strip, Trol-E Duct or similar system		.20 per ft		
22	Signs, Electric - .10 ea. socket, plus .50 ea. add'l. transformer		8.00 min		
23	Swimming Pool Wiring: A. Inground pools		40.00		
24	B. Above ground pools		25.00		
25	Spas, Hot-tubs, Hydromassage Bathtubs	1	6.00	6	
26	MINIMUM CHARGE FOR ANY ONE PERMIT		20.00 ea		
27	FAILURE TO CALL FOR FINAL INSPECTION		15.00		
28	DOUBLE FEES will be charged for any work started before obtaining permit.				

#33293
Receipt 32 50
~~32 50~~

The undersigned hereby makes application for a permit for the execution of electrical installation for light, heat or power as prescribed and agrees to comply with all applicable State and Local Codes and Ordinances regulating the installation of electrical wiring and equipment in the Village of Fox Point.

TOTAL FEES 32 50

MAKE CHECKS PAYABLE TO:
Treasurer, Village of Fox Point
MAIL TO: Electrical Inspector

Contractor <u>K-W-K ELECTRIC</u>	Supervising Electrician (Signature) <u>Kenneth W Kmet</u> Date <u>10-18-93</u>
Address <u>13747 N LAKE SHORE DR</u>	Telephone <u>243-9525</u>
City <u>MEQUON WISC</u> State <u>WISC</u> Zip Code <u>53097</u>	

6

APPLICATION FOR BUILDING PERMIT

TO THE BUILDING INSPECTION DEPARTMENT:

The undersigned hereby applies for a permit to build, in accordance with the information tabulated hereafter,

Type of Structure Bedroom and Renovation of Family Room
Residence, Garage, Store, Office, School, Fence, Shed, Sign, Swimming Pool, Etc.

Address 1015 E Churchill Lane

Lot Block

Subdivision

District

Does contemplated structure violate the Village zoning ordinance?

Height of Structure 1 story (stories or feet)

Width (parallel to highway) (feet) Depth (perpendicular to highway) (feet)

Distance: Street Line to Front Line of Structure (feet)

Distance: Side Lot Line to Structure

Type of Construction: Frame Brick tile, Etc. Exterior finish Brick Stucco, Siding, Brick Veneer, Etc.

Height of front yard above street grade

Number of rooms Baths

Estimated cost Garage Building 42000 Structure

Is there a private garage?

Does the contemplated garage violate the Village zoning ordinance?

Size Number of stalls

Where situated

General construction Frame - Brick - Stucco - Etc.

Have plans been submitted to the Wisconsin Department of Industry, Labor and Human Relations for examination and approval?

Have plans been approved as being in compliance with all applicable sections of the Wisconsin Administrative code?

Herewith are filed the following duplicate plans in number, which I certify I will conform to in the work hereby applied for.

Remarks:

Herewith are filed the specifications that describe the work in question and as shown on plans above submitted.

In making the application the undersigned agrees to obey the Fox Point Building and Zoning Codes pertaining to the erection of all structures and also agrees to obey all other ordinances of the Village of Fox Point.

The undersigned, owner or being duly authorized so to do, hereby gives express authorization to the Village of Fox Point, its officers, agents and employees, to enter upon the premises herein described and fill up any excavation, or tear down, remove or enclose the unfinished structure for which a permit is herein requested in the event of cessation of the building, whenever the Building Inspector shall determine that such premises in the unfinished condition of the structure are dangerous to members of the public, including children, even though trespassers. The undersigned further hereby waives all statutory notices and consents to the determination by the Village Board and the levy and placing upon the tax roll of a special assessment in the amount of the cost to the Village, including customary Village overhead charges incurred in filling up any such excavation or tearing down, removing or enclosing any such unfinished structure.

We hereby agree to provide a house number plate or sign readily observable from the public highway which will be installed not less than 15 days after the structure is occupied.

Owner of Structure Gary Taxman Arch. or Contr. B+E General Contr Inc

Address 1015 E Churchill Lane Address 9049 N Lake Dr

City Fox Point City MILW WI 53217

State Zip State Zip

Phone 351 0027 Phone 351-5558

Size of Structure (sq. ft.) Permit Fee \$250 PD herewith tendered

Date Submitted Date Approved 8/25/93 Signed [Signature]

Date of Permit Architect, Owner, Builder

VILLAGE OF FOX POINT

7200 N. SANTA MONICA BLVD.
FOX POINT 53217
414-351-8900

OFFICE USE ONLY	
Permit No.	12483E
Received	8/13/91
Service	8-14-91
Rough-in	
Final	

APPLICATION FOR ELECTRICAL PERMIT

Date 8-13-91
License No. 123 59

PLEASE TYPE OR PRINT WITH BALL POINT PEN

Builder	Owner <u>GARY TAXMAN</u>	Occupant <u>GARY TAXMAN</u>
Job Address <u>1015 E CHURCHILL LN</u>		

ESTIMATED COST OF JOB 900

- Buildings Residential
 Commercial
 Industrial
 Institutional
 New Construction
 Additional Rooms
 Remodeling
 New Occupancy

Where on Premises?
Describe BASEMENT WEST

List Name of Installing Contractor
 HEATING _____
 AIR CONDITIONING _____
 PLUMBING _____

Date of Inspection	
Rough _____	Will Call <input type="checkbox"/>
Final _____	Will Call <input type="checkbox"/>
Service Approval Sent <u>8-14</u>	<input type="checkbox"/>

REMARKS: Please inspect 8-14-91

No.	Description	Qty.	Rate of Fees	Dollars	Cents
1	Light, switch and convenience outlets		.35 ea		
2	Lighting Fixtures		.30 ea		
3	Fluorescent Fixtures - per tube		.30 ea		
4	Range, Electric		4.00 ea		
5	Garbage Grinding and Disposal Unit		3.00 ea		
6	Dishwasher		4.00 ea		
7	Clothes Dryer		4.00 ea		
8	Water Heaters, Electric		4.00 ea		
9	Gas Burner, Oil Burner or Stoker		5.00 ea		
10	Refrigerating, Air Cooling or similar machine - .25 per HP		5.00 min		
11	Feeders - No. 6 A.W.G. or Larger		7.00 ea		
12	Temporary Service Permit for: How Long?		10.00 ea		
13	Services: Service Switches, ea.		5.00 ea		
	Service 1. 0 through 100 amps.		5.00 ea		
	2. 101 through 400 amps.	1	10.00 ea	10	00
	3. 401 through 600 amps.		10.00 ea		
	4. 601 through 1000 amps.		15.00 ea		
	5. Thereafter, ea. additional 1000 amps.		5.00 ea		
14	Motors over 1/4 HP		.30 per HP or frac		
15	Fuel Dispensing Pumps		6.00 ea		
16	Transformers, Rectifiers and Generators		.30 per KW		
17	Space Heating Systems, per circuit		3.00 ea		
18	Power receptacles - 120 Volts or over 1. Through 30 amps		3.00 ea		
19	2. Over 30 amps		5.00 ea		
20	Wireways, busways, underfloor raceways or auxillary gutters		.25 per ft		
21	Strip Lighting, Plug-in Strip, Trol-E Duct or similar system		.20 per ft		
22	Signs, Electric - .10 ea. socket, plus .50 ea. add'l. transformer		8.00 min		
23	Swimming Pool Wiring: A. Inground pools		40.00		
24	B. Above ground pools		25.00		
25	Spas, Hot-tubs, Hydromassage Bathtubs		6.00		
26	MINIMUM CHARGE FOR ANY ONE PERMIT		20.00 ea	20	00
27	FAILURE TO CALL FOR FINAL INSPECTION		15.00		
28	DOUBLE FEES will be charged for any work started before obtaining permit.				

TOTAL FEES 30 00
 MAKE CHECKS PAYABLE TO:
 Treasurer, Village of Fox Point
 MAIL TO: Electrical Inspector

The undersigned hereby makes application for a permit for the execution of electrical installation for light, heat or power as prescribed and agrees to comply with all applicable State and Local Codes and Ordinances regulating the installation of electrical wiring and equipment in the Village of Fox Point.

Contractor <u>K-W-K. ELECTRIC</u>	Supervising Electrician (Signature) <u>Kenneth W Knoff</u> Date <u>8-13-91</u>
Address <u>13747 N LAKE SHORE DR</u>	Telephone <u>243-9525</u>
City <u>MEQUON</u> State <u>WISC</u> Zip Code <u>53092</u>	

This Permit is void if work is not started within 2 months, or if started, no work is done for 2 months.

Rec. # 12628 \$25.00 cash

INSPECTION DEPARTMENT
VILLAGE OF FOX POINT
7200 N. SANTA MONICA BOULEVARD
MILWAUKEE, WISCONSIN 53217

APPLICATION FOR INSPECTION AND ISSUANCE
OF CERTIFICATE OF COMPLIANCE

(Please type or print clearly)

No. 1917 Date 5/13/85

Address 1015 E. Churchill Lane Fox Point, Wisconsin.

Type of Proposed Occupancy Single Family

Owner of Building Robert & Sandra Bukowsky

Building Owner's Address:
Same

Building Owner's Telephone Number (414) 351-3528
area code

Proposed Occupant's Name (if known) _____

Proposed Occupant's Present Address:

Proposed Occupant's Telephone Number () _____
area code

If a certificate of compliance will not be issued unless repairs or alterations are performed, they will be made by:

Owner _____ Proposed Occupant _____ Other

Sandra S. Bukowsky
Applicant's Signature

1015 E. Churchill Lane
Applicant's Address

NOTE: A copy of a Certificate of Compliance or Notice of Noncompliance will be given to all persons named above.

Application and fee received: Date 5-13-85

Received by TC

Inspection made: Date 5-20-85

Signature Carl H. [Signature]

INSPECTION DEPARTMENT
VILLAGE OF FOX POINT
7200 N. SANTA MONICA BOULEVARD
FOX POINT, WISCONSIN 53217

CERTIFICATE OF COMPLIANCE

No. 1746

Date May 21, 1985

Issued to Robert & Sandra Bukowsky

Address 1015 E. Churchill Lane

This Certificate of Compliance permits a change in the occupancy of the premises located at 1015 E. Churchill Lane in Fox Point, Wisconsin, any time within one year from the date hereof, and indicates that so far as can reasonably be determined by a visual inspection of the premises and a review of the Village records, the premises meet the requirements of Section 30P.62 of the Fox Point Building Code. This certificate is issued for the benefit of the Village of Fox Point in the enforcement of Section 30P.62 of the Fox Point Building Code. Neither the Village of Fox Point nor the Building Inspector assumes any liability in or as a result of the inspection or issuance of this Certificate of Compliance and by the issuance of this Certificate of Compliance does not guarantee or warrant as to the condition of the premises inspected.



Building Inspector
Village of Fox Point

VILLAGE OF FOX POINT
MILWAUKEE COUNTY, WISCONSIN

Rec. # 7344
No. 6914 *gmo*

APPLICATION FOR BUILDING PERMIT

TO THE BUILDING INSPECTION DEPARTMENT:

The undersigned hereby applies for a permit to build, in accordance with the information tabulated hereafter,

Type of Structure Fence
Residence, Garage, Store, Office, School, Fence, Shed, Sign, Swimming Pool, Etc.

House Number 1015 E. Churchill Lane

Lot 3 Block 2

Subdivision Fox Point

District _____

Does contemplated structure violate the Village zoning ordinance? No

Height of Structure 6 feet (stories or feet)

Width (parallel to highway) 6" (feet) Depth (perpendicular to highway) 21' (feet)

Distance: Street Line to Front Line of Structure 63 (feet)

Distance: Side Lot Line to Structure on West Lot Line (State)

Type of Construction: Wood Exterior finish Stained
Frame, Brick-tile, Etc. Stucco, Siding, Brick Veneer, Etc.

Height of front yard above street grade _____

Number of rooms _____ Baths _____

Garage _____

Estimated cost Building _____

Structure \$200

Is there a private garage? Yes

Does the contemplated garage violate the Village zoning ordinance? _____

Size _____ Number of stalls _____

Where situated _____

General construction _____
Frame — Brick — Stucco — Etc.

Have you applied to the Industrial Commission for a permit under the State Building Code? No

Has the permit been granted? _____

Herewith are filed the following duplicate plans _____ in number, which I certify I will conform to in the work hereby applied for.

Remarks: _____

Herewith are filed the specifications that describe the work in question and as shown on plans above submitted.

In making the application the undersigned agrees to obey the Fox Point Building and Zoning Codes pertaining to the erection of all structures and also agrees to obey all other ordinances of the Village of Fox Point.

The undersigned, owner or being duly authorized so to do, hereby gives express authorization to the Village of Fox Point, its officers, agents and employees, to enter upon the premises herein described and fill up any excavation, or tear down, remove or enclose the unfinished structure for which a permit is herein requested in the event of cessation of the building, whenever the Building Inspector shall determine that such premises in the unfinished condition of the structure are dangerous to members of the public, including children, even though trespassers. The undersigned further hereby waives all statutory notices and consents to the determination by the Village Board and the levy and placing upon the tax roll of a special assessment in the amount of the cost to the Village, including customary Village overhead charges incurred in filling up any such excavation or tearing down, removing or enclosing any such unfinished structure.

We hereby agree to provide a house number plate or sign readily observable from the public highway which will be installed not less than 15 days after the structure is occupied.

Owner of Structure Robert & Sandra Bukowsky Arch. or Contr. J. D. Griffiths

Address 1015 E. Churchill Lane Address 7309 N 76th

Phone 351-3528 Phone 353-4411

Size of Structure _____ (sq. ft.) Permit Fee \$20.00 herewith tendered

Date Submitted 11/2/82

Date Approved 11-1-82 Signed Sandra Bukowsky

Date of Permit _____ Architect, Owner, Builder

INSPECTION DEPARTMENT
VILLAGE OF FOX POINT
7200 N. SANTA MONICA BOULEVARD
MILWAUKEE, WISCONSIN 53217

APPLICATION FOR INSPECTION AND ISSUANCE
OF CERTIFICATE OF COMPLIANCE

(Please type or print clearly)

No. 726 Date 3-2-79

Address 1015 E Churchill lane Fox Point, Wisc.

Type of Proposed Occupancy: Single Family home

Owner of Building John W. + Marion Coffey

Building Owner's Address:

same
No. Street City State Zip

Building Owner's Telephone No. (414) 352-1166
area code

Proposed Occupant's Name (if known) _____

Proposed Occupant's Present Address:

same
No. Street City State Zip

Proposed Occupant's Telephone No. () _____
area code

If a certificate of compliance will not be issued unless repairs or alterations are performed, they will be made by:

Owner same Proposed Occupant _____ Other _____

[Signature]
Applicant's signature

Applicant's address

NOTE: A copy of certificate of compliance or noncompliance will be given to all persons named above.

Application and fee received: Date 3/6/79 Rec # 1026

Signature [Signature]

Inspection Made: Date 3-7-79

Signature [Signature]

INSPECTION DEPARTMENT
VILLAGE OF FOX POINT
7200 N. SANTA MONICA BOULEVARD
MILWAUKEE, WISCONSIN 53217

CERTIFICATE OF NONCOMPLIANCE

March 7, 1979

Date

Issued to John L. & Marlon Coffey

Address 1015 East Churchill Lane

An inspection of the premises located at 1015 East Churchill
Lane discloses noncompliance with codes
or ordinances of the Village of Fox Point as hereafter listed.

1. Eliminate clear water from sanitary sewer.
2. Replace missing electrical box cover in basement.
3. Remove wood form boards below fireplace hearth.
4. Maximum uniform rise for step is 8"-step from residence to garage
is excessive.

The premises at the above address shall be brought into compliance before there is a change in occupancy. Please notify this office when corrections have been made and a reinspection of the premises for compliance is desired.

Earl H. Plank

Building Inspector
Village of Fox Point

INSPECTION DEPARTMENT
VILLAGE OF FOX POINT
7200 N. SANTA MONICA BOULEVARD
MILWAUKEE, WISCONSIN 53217

CERTIFICATE OF COMPLIANCE

No. 790 Date August 7, 1979

Issued to John L. & Marlon Coffey

Address 1015 E. Churchill Lane

This Certificate of Compliance permits a change in occupancy of the premises located at 1015 E. Churchill Lane

in Fox Point, Wisconsin, any time within one year from the date hereof, and indicates that so far as can reasonably be determined by a visual inspection of the premises and a review of the Village records, the premises meet the requirements of Section 30P.62 of the Fox Point Building Code. This certificate is issued for the benefit of the Village of Fox Point in the enforcement of Section 30P.62 of the Fox Point Building Code. Neither the Village of Fox Point nor the Building Inspector assumes any liability in or as a result of the inspection or issuance of this Certificate of Compliance and by the issuance of this Certificate of Compliance does not guarantee or warrant as to the condition of the premises inspected.

COPY SENT TO
OBDEN CO. INC.
ATTN. C. HANLUND

Carl H. Blank
Building Inspector
Village of Fox Point

1109

VILLAGE OF FOX POINT
MILWAUKEE COUNTY, WISCONSIN

No. 1939

Rec #16897
5/25/61
\$ 4.00
C.H.H.

APPLICATION FOR HEATING PERMIT

TO THE BUILDING INSPECTION DEPARTMENT:

The undersigned hereby applies for a permit to install, in accordance with the information tabulated hereafter,

Winter Air Conditioner

Fuel: Gas Oil Coal : Other _____

Type: 2 Gas forced air heating system.
Forced Air, Radiant, Baseboard, Etc.

Desc. of Heating Plant _____

X Vented to Cement Chimney

Fuel Tank : _____
Size Location

Summer Air Conditioner

Size _____ (Ton, H.P.)

Coolant _____

Compressor Coolant: Air ; Water ;

If Water Cooled:
Source of Water _____
Discharged to _____

Remarks 2- Gas Fee 4.00

The undersigned acknowledges that he is familiar with Ordinances No. 158, 229, and all amendments thereto and that the work described herewith shall conform in all respects to said ordinances and all other ordinances of the Village of Fox Point, and laws of the State of Wisconsin. Any variations of the above may cause immediate revocation of the permit, if granted.

Owner John Coffey

Address of Work 1015 E. Churchill Lane

Lot Block Subdivision

Contractor Milwaukee Furnace &

Address 2138 W. National Ave Phone Wa 5-8469

Approved: _____
Signed

5-25-61

5/22/61
Date

1109

VILLAGE OF FOX POINT

MILWAUKEE COUNTY, WISCONSIN

Rec'd 16707

No. 3681 3/7/61

APPLICATION FOR BUILDING PERMIT

Ch
CEN

TO THE BUILDING INSPECTION DEPARTMENT:

The undersigned hereby applies for a permit to build, in accordance with the information tabulated hereafter,

Designation addition to residence
Duplex, Residence, Apartment, Store, Garage, Theatre

House Number 1015 E. Churchill Lane

Lot 3 Block 2

Subdivision Fox Point

District B residential

Does contemplated building violate the Village zoning ordinance? no

Height of Building 1 story (stories or feet)

Width (parallel to highway) 19'6" (feet) Depth (perpendicular to highway) 15'6" (feet)

Distance: Street Line to Front Line of Porch..... (feet)

Distance: Side Lot Line to Structure 31.13

Type of Construction: brick Exterior finish brick
Frame, Brick-tile Stucco-Siding-Brick Veneer

Height of front yard above street sidewalk grade.....

Number of rooms 1 Baths.....

Estimated cost { Garage.....
Building \$5000

Is there a private garage? yes

Does the contemplated garage violate the Village zoning ordinance?.....

Size..... Number of stalls.....

Where situated.....

General construction.....
Frame-Brick-Stucco

Have you applied to the Industrial Commission for a permit under the State Building Code?.....

Has the permit been granted?.....

Herewith are filed the following duplicate plans..... in number, which I certify I will conform to in the work hereby applied for.

Remarks: ~~845,000~~ SQ. FOOTAGE OF OPEN AREA UNDER REQUIRED 15,000 SQ. FT.
APPROVED BY ORDER OF VILLAGE MANAGER, C.H.S.

Herewith are filed the specifications that describe the work in question and as shown on plans above submitted.

In making the application the undersigned agrees to obey the Fox Point Building Code pertaining to the erection of buildings and also agrees to obey all other ordinances of the Village of Fox Point.

The undersigned, owner or being duly authorized so to do, hereby gives express authorization to the Village of Fox Point, its officers, agents and employees, to enter upon the premises herein described and fill up any excavation, or tear down, remove or enclose the unfinished structure for which a permit is herein requested in the event of cessation of the building, whenever the Building Inspector shall determine that such premises in the unfinished condition of the structure are dangerous to members of the public, including children, even though trespassers. The undersigned further hereby waives all statutory notices and consents to the determination by the Village Board and the levy and placing upon the tax roll of a special assessment in the amount of the cost to the Village, including customary Village overhead charges incurred in filling up any such excavation or tearing down, removing or enclosing any such unfinished structure.

We hereby agree to provide a house number plate or sign readily observable from the public highway which will be installed not less than 15 days after the residence is occupied.

Owner of Structure John P. Doffy Arch. or Contr.....

Address 1015 E. Churchill Lane Address.....

Phone FL-2-1166 or BR-6-5800 Phone..... (565)

Size of Structure 302 (sq. ft.) Permit Fee \$6.00 herewith tendered

Date Submitted March 1, 1961

Date Approved March 3, 1961 Signed John P. Doffy

Date of Permit..... Architect, Owner, Builder

5/24/50

cash

VILLAGE OF FOX POINT
MILWAUKEE COUNTY, WISCONSIN

No. 2125

APPLICATION FOR PERMIT

TO THE INSPECTION DEPARTMENT:

The undersigned hereby applies for a permit for the execution of electrical installation for light, heat or power, as hereinafter prescribed.

- 1. Location 1015 Church Hill Lane
(Give exact street and number. Do not give corner.)
- 2. Owner Wm. Treichel
- 3. Lot _____ Block _____ Subdivision _____
- 4. Building or structure _____
- 5. Contractor Moer Electric Licence No. _____

	Number	Rate of Fees	Fees
6. Lighting Outlets	95	@ \$.10	9.50
7. Fixtures		" .05	
8. Range Circuit or Outlet		" 1.00	1.00
9. Range Connection		" 1.00	
10. Water Heaters & other Heating Devices	1st Kilowatt	" 1.00	1.00
	Each Additional Kilowatt	" .10	
11. Refrigerating Machines		" 2.00	
12. Oil Burners and Stokers		" 1.00	
13. Temporary Permits	Inspection per Hour	" 2.00	2.00
14. Motors	H.P.-H.P.-H.P. per H.P.	" .10	
15. Studded Lights including their Individual Outlets		" .05	
16. Rectifiers and Transformers		" 1.00	

Estimated cost \$ _____ Total fees \$ 12.50

Date of inspection { Wiring _____ 19 _____ Note: Minimum Fee \$1.00
 { Fixtures _____ 19 _____

Enclosed please find \$ _____

It is hereby agreed between the undersigned person, firm or corporation and the Village of Fox Point that for and in consideration of the premises and of the permit for the execution of the electrical installation, for light, heat or power, as particularly described in this application, the work will be done in accordance with all of the provisions of all ordinances regulating the installation of electrical work, electric wiring and apparatus in the Village of Fox Point and all of the subsequent amendments thereto.

Signed Francis M. Moer
 Address Shirleyville, Wis.

10/9/50

VILLAGE OF FOX POINT
MILWAUKEE COUNTY, WISCONSIN

No. 2299

APPLICATION FOR PERMIT

TO THE INSPECTION DEPARTMENT:

The undersigned hereby applies for a permit for the execution of electrical installation for light, heat or power, as hereinafter prescribed.

- 1. Location 1015 E Church Hill Lane
(Give exact street and number. Do not give corner.)
- 2. Owner Wm Sreedel
- 3. Lot _____ Block _____ Subdivision _____
- 4. Building or structure Wm Residence
- 5. Contractor R. Franzel Licence No. _____

	Number	Rate of Fees	Fees	Cash
6. Lighting Outlets		@	\$.10	
7. Fixtures		"	.05	
8. Range Circuit or Outlet		"	1.00	
9. Range Connection		"	1.00	
10. Water Heaters & other Heating Devices	1st Kilowatt	"	1.00	
	Each Additional Kilowatt	"	.10	
11. Refrigerating Machines		"	2.00	
12. Oil Burners and Stokers		"	1.00	1.00
13. Temporary Permits	Inspection per Hour	"	2.00	
14. Motors	H.P.-H.P.-H.P. per H.P.	"	.10	
15. Studded Lights including their Individual Outlets		"	.05	
16. Rectifiers and Transformers		"	1.00	
Estimated cost \$				
Total fees				1.00

Date of inspection { Wiring anytime 19____
 { Fixtures 19____

Note: Minimum Fee \$1.00

Enclosed please find \$ _____

It is hereby agreed between the undersigned person, firm or corporation and the Village of Fox Point that for and in consideration of the premises and of the permit for the execution of the electrical installation, for light, heat or power, as particularly described in this application, the work will be done in accordance with all of the provisions of all ordinances regulating the installation of electrical work, electric wiring and apparatus in the Village of Fox Point and all of the subsequent amendments thereto.

Signed Richard J. Franzel
 Address 3700 W. V. Hill (6)

2 Story -
2005 sq. ft.

VILLAGE OF FOX POINT

MILWAUKEE COUNTY, WISCONSIN

No. 1109

APPLICATION FOR BUILDING PERMIT

TO THE BUILDING INSPECTION DEPARTMENT:

The undersigned hereby applies for a permit to build, in accordance with the information tabulated hereafter,

Designation Residence and Garage
Duplex, Residence, Apartment, Store, Garage, Theatre

House Number 1015 E. Churchill Lane STREET

Lot 3 Block 2

Subdivision Fox Point Subd.

District B. Residence

Does contemplated building violate the Village zoning ordinance? No

Height of Building 2 2 Story (stories or feet)

Width (parallel to highway) 69 ft. including garage (feet)

Depth (perpendicular to highway) 51 ft. (feet)

Distance: Street Line to Front Line of Porch 60 feet to center line of E. Churchill Lane (feet)

Type of Construction: Frame
Frame, Brick-Tile

Exterior finish Brick and Siding
Stucco-Siding-Brick Veneer

Height of front yard above street sidewalk grade 12" above road crown

Number of rooms 7 rooms and 2 Baths.

Estimated cost { Garage
& Building \$

Is there a private garage? Yes

Does the contemplated garage violate the Village zoning ordinance? No

Size 24 ft. X 21 ft. Number of stalls 2

Where situated attached to residence

General construction Frame and Brick
Frame-Brick-Stucco

Have you applied to the Industrial Commission for a permit under the State Building Code?

Has the permit been granted?

Herewith are filed the following duplicate plans in number, which I certify I will conform to in the work hereby applied for.

Remarks: Approve - Incinerator or garbage Disposal will be installed
The dividing wall below garage and Breezeway shall be 8" masonry or
1" of Plaster on metal Lath to roof Boards. Door to be 1-3/4" thick
flush wood door or metal clad.

Herewith are filed the specifications that describe the work in question and as shown on plans above submitted.

In making the application the undersigned agrees to obey the Fox Point Building Code pertaining to the erection of buildings and also agrees to obey all other ordinances of the Village of Fox Point.

The undersigned, owner or being duly authorized so to do, hereby gives express authorization to the Village of Fox Point, its officers, agents and employees, to enter upon the premises herein described and fill up any excavation, or tear down, remove or enclose the unfinished structure for which a permit is herein requested in the event of cessation of the building, whenever the Building Inspector shall determine that such premises in the unfinished condition of the structure are dangerous to members of the public, including children, even though trespassers. The undersigned further hereby waives all statutory notices and consents to the determination by the Village Board and the levy and placing upon the tax roll of a special assessment in the amount of the cost to the Village, including customary Village overhead charges incurred in filling up any such excavation or tearing down, removing or enclosing any such unfinished structure.

Owner of land W. E. Treichel Owner of building W. E. Treichel

Permit fee \$7.49 herewith tendered.

Signed W. E. Treichel

Dated, April 13, 19 50

Architect, Owner, Builder.

4/15/50
Rec No 4891 Culvert 575

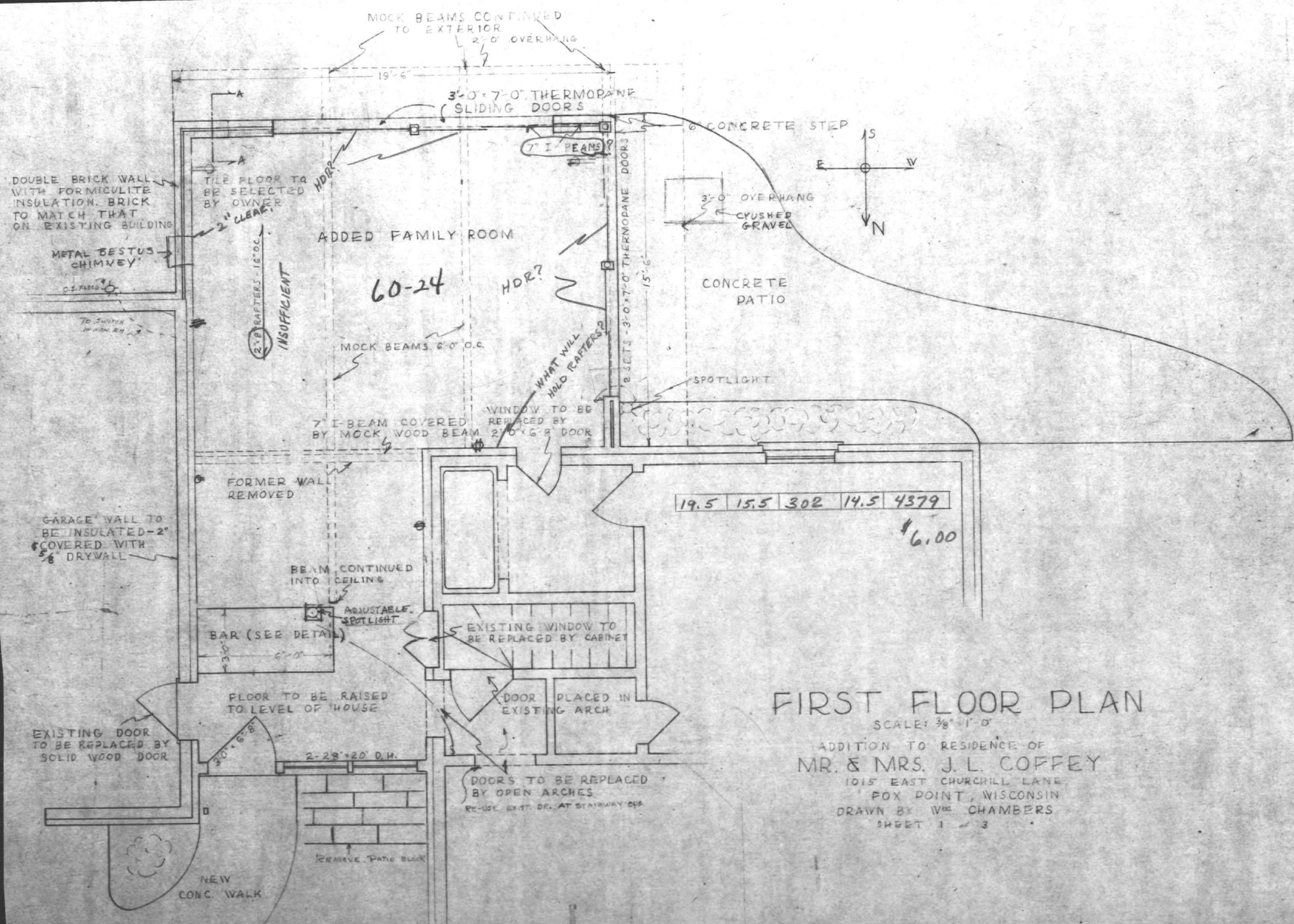

19.5 15.5 302 14.5 4379

\$6.00

FIRST FLOOR PLAN

SCALE: 3/8" = 1'-0"

ADDITION TO RESIDENCE OF
MR. & MRS. J. L. COFFEY

1015 EAST CHURCHILL LANE
FOX POINT, WISCONSIN

DRAWN BY Wm. CHAMBERS
SHEET 1 - 3

attach to Per. #110

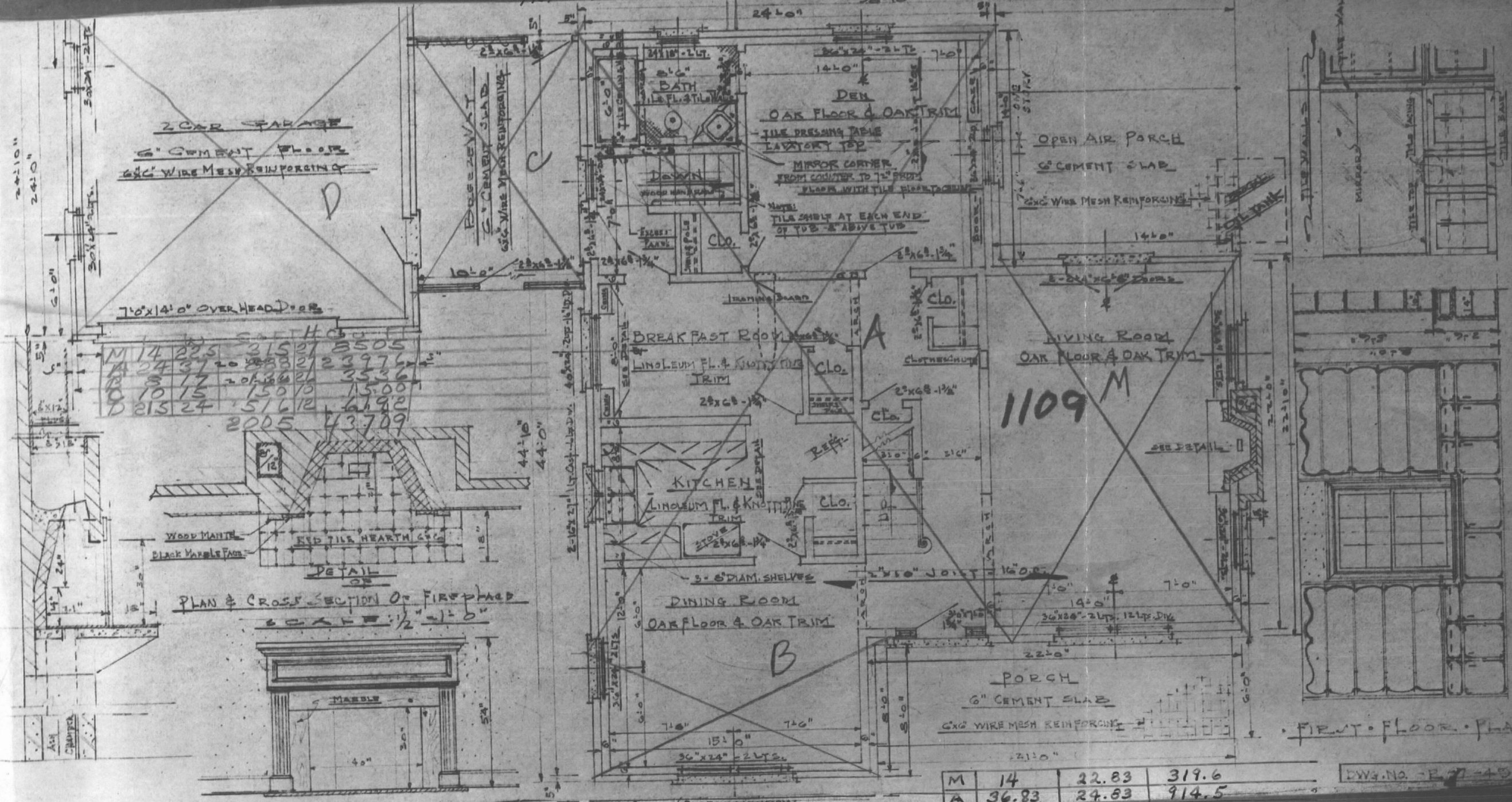

M	14	22.5	315.21	850.5
A	36.83	24.83	914.5	
B	8	16.83	134.6	
C	10	15	150.0	
D	21.5	24	516.12	619.2
		200.5	437.09	

PLAN & CROSS SECTION OF FIREPLACE
SCALE: 1/2" = 1'-0"

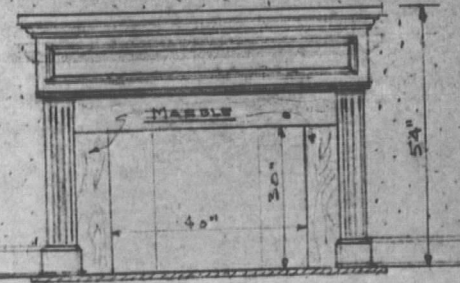

M	14	22.83	319.6
A	36.83	24.83	914.5
B	8	16.83	134.6
			1368.7

Rechecked
March '55 Rfj.

1 STORY AREA 6.5 x 24.83 161

FIRST FLOOR PLAN

DWG. NO. - P-7-43

SEWER AND PLUMBING DEPARTMENT

Permit No. 498 Application No. 7484 Fox Point, WI 10/25/93 19

Permission is hereby given to do the necessary plumbing work on the premises of _____ described as follows:

Lot	Block	Subdivision

Located at 1015 E Churchill

The above named is permitted to employ Bill Zachtow

License No. MP 3947 for the purpose of laying a _____ inch _____

Sanitary Building Sewer from Main to Curb to Lot line to Premises. Connection to be made in _____ feet _____ of _____

Laying a _____ inch _____ Building Storm Sewer _____

Fixtures with drain or water connection:

	No.		No.		No.
Hose Bibs		Water Heaters		Water Closets	<u>(2)</u>
Bath Tubs	<u>(1)</u>	Wash Mach Waste		Showers	<u>(2)</u>
Sump Pumps		Bidets		Floor Drains	
Laundry Trays		Catch Basins		Food Waste Grinders	
Drinking Fountains		Dishwashers		Sprinkling Systems	
Sinks		Wash Basins	<u>(3)</u>	Urinals	

as per application made subject to the Rules and Regulations of the Village Board and of Chapter 12 of the Fox Point Village Code.

Building Sewer \$ _____

Fixtures \$ 4000

Building Drain \$ _____

Rec'd for Permit \$ Receipt # 33249

[Signature]
Plumbing Inspector

Village of Fox Point, Milwaukee County, Wisconsin
Inspector of Buildings Department

Certificate of Electrical Inspection

To Wis. Elec. Power Co.: Relative to

Premises..... 1015 E. Churchill Lane Fox Point

Owner..... Gary Taxman

This is to Certify, that electrical work done under Permit No. 12483 issued by this

DEPARTMENT to..... is in conformity with the provisions of the Electrical Code of the Village of Fox Point, Milwaukee County, Wisconsin.

INSTALL:

- Service to Temporary Pole Temporary Service and Meter to Building Permanent Service to Building Hot Water Heater Service and Meter Other.....

Remarks:.....

Dated..... August 13, 1991

Scott Miller
.....
Electrical Inspector, Village of Fox Point.

SEWER AND PLUMBING DEPARTMENT

Permit No. 4681 Application No. 4841 Fox Point, Wis. Oct. 15, 1979

Permission is hereby given to do the necessary draining and plumbing work on the premises of Mr. Coffey described as follows:

Description	Lot	Blk.	Subd.
-------------	-----	------	-------

being No. 1015 on the South side of E. Churchill Lane

The above named is permitted to employ Otto Kolsch a Licensed Plumber for the purpose of laying a 4 inch Sanitary Sewer drain pipe from Main to Curb to Lot line to Premises. Connection to be made in 4 feet of

Or of laying a 4 inch Storm Sewer Drain pipe

Fixtures with drain or water connection

	No.		No.		No.
Bath tubs		Sump Pump		Wash Basins	
Laundry tubs		Sinks		Water Closets	
Basement drains		Showers		Hot Water Heater	1
Dishwasher				Garbage Disposal	

as per application made subject to the Rules and Regulations of the Village Board and of Chapter 12 of the Fox Point Village Code.

Received for Permit \$ 5.00 Dollars

Received for Fixtures \$ _____ Dollars

Earl W. Plunk
PLUMBING INSPECTOR

PERMIT CLERK

SEWER AND PLUMBING DEPARTMENT

Permit No. 1149 Application No. 1225 Fox Point, Wis. May 16 1950

Permission is hereby given to do the necessary draining and plumbing work on the premises of W. E. Truchel described as follows:

Description	Lot	Blk.	Subd.
<u>Fox Point</u>	<u>3</u>	<u>2</u>	

being No. 1015 on the W side of Churchill St.
 The above named is permitted to employ W. E. Truchel a Licensed Plumber for the purpose of laying a 6 inch Clay Sanitary Sewer drain pipe from Main to Curb to Lot line to Premises. Connection to be made in Main feet 1479 E. of 1st North St. of M. H. at
 Or of laying a 4 inch of 4" Submain Storm Sewer Drain pipe to Churchill Lane

Fixtures with drain or water connection

	No.		No.		No.
Bath tubs	<u>2</u>	Urinals		Wash Basins	<u>2</u>
Laundry tubs	<u>1</u>	Sinks	<u>1</u>	Water Closets	<u>3</u>
Basement drains	<u>1</u>	<u>Hot Water Heat</u>	<u>1</u>	<u>Disposal</u>	<u>1</u>
			<u>1</u>	<u>Diswasher</u>	<u>1</u>

as per application made subject to the Rules and Regulations of the Village Board and of Ordinance No. 56 of the Village of Fox Point and amendments.

75 Truchel
 Received for Permit \$ 6.25
Hot Water Heat
 Received for Fixtures \$ 100 Dollars
12 @ .50
6.00 Dollars
13.25

PLUMBING INSPECTOR

PERMIT CLERK

Wisconsin Electric Power Company
OUTLET LOCATION LETTER

REVISION
 DUPLICATE

To KWK ELEC. Date Prepared 7-30-91

In regard to your inquiry of _____ for (Overhead) (Underground) service to the (industrial) (commercial) (residential) (farm) premise of GARY TAXMAN located at 1015 E CHURCHILL LN in the C/T/V of FOXPOINT we require service termination as follows:

New Temporary Rewired Additional
Single Phase 200 amperes, (120/240) volts, termination located SAME LOCATION - W. WALL S.W. CORNER

at _____ foot minimum above (ground) (final grade)
 per Electric Service and Metering Manual Sheets 4-10 + 4-11
 Meter Location (out) (in) side at: TERMINATION

Service (drop) (lateral) size 310 TXR length 125 tension _____

Maximum Single-phase Available Short Circuit Current at the service termination.
 10,000 amperes 22,000 amperes _____ amperes

New Temporary Rewired Additional Power
(Single) (Three) Phase _____ amperes (240) (120/208) (480) _____ volts, termination located _____

at _____ foot minimum above (ground) (final grade).
 per Electric Service and Metering Manual Sheets _____
 Meter Location (out) (in) side at: _____

Service (drop) (lateral) size _____ length _____ tension _____

Maximum (Single) (Three) phase Available Short Circuit Current at the service termination.
 22,000 amperes 25,000 amperes _____ amperes

- Installation of WE facilities involves (additional) charges. Billing must be satisfied prior to construction.
- The above information is valid for _____.
- The above information is contingent upon right-of-way.
- The above information is contingent upon _____.

You are advised NOT to proceed with completion of wiring until notified the contingencies noted above have been removed.

On _____ you were advised not to proceed with the completion of the wiring. All the contingencies have been removed and you may proceed.

You may proceed with the completion of wiring.

The location of service drops supports for buildings covered with aluminum, stucco, asbestos, or other similar siding material shall be marked. Mounting bolts were provided by the Company and shall be installed by the owner, or by his contractor for him, on brick and stone buildings.

Refer Inquiries to B. JELLIS

NOTICE TO CUSTOMER/ELECTRICIAN

Prepared by _____

Information provided in this letter does not supersede the National, State or Local Electrical Codes. The final responsibility for compliance with the various electrical codes lies with the customer and/or the customer's electrician.

CALUMET District

Phone 354-8100

Clerk: Send this form to 13747 N. LAKESHORE DR
MEQUON 53092

243-9525

DEPARTMENT OF ELECTRICAL INSPECTION

Application for Permit for Electrical Installation

VILLAGE OF FOX POINT

Permit 16915
6/2/61
cash

TO THE ELECTRICAL INSPECTOR:

Date June 2/61

The undersigned hereby applies for a permit for the execution of electrical installation for light, heat, or power, as hereafter prescribed:

Location: 1015 E Churchill Ln
(Give exact street and number. Do not give corner)

Elec. Contractor: Edwards Electric Service Address: 1517 5073rd St

Builder: Address: _____

Owner: John J Coffey Address: _____

What is occupancy of the building NEW OLD

cash

1. Outlets	14	each	\$.15	2	10
2. Fixtures	5	each	.10		50
3. Fixtures — fluorescent, cold cathode, lumiline, mercury vapor		each lamp	.10		
4. Audible or visual devices		per device	.10		
5. Exhaust and ventilating fans and their control (below 1 H.P.)	1	each	.50		50
6. Built-in electric heaters; bathroom, nursery, etc		each	.50		
7. Garbage Disposal		each	.50		
8. Dishwasher		each	.50		
9. Clothes dryer		each	.50		
10. Range or other receptacles over 150 volts		each	.50		
11. Water heater		each	.50		
12. Automatic heating equipment — gas, oil, coal	2	each	2.00	4	00
13. Automatic water systems		each	1.00		
14. Refrigerating, air conditioning, etc., machines		each	2.00		
15. Strip lighting, plug in strip, trol-e-duct, etc		per ft.	.03		
16. Dimmers or Time Clocks		each	.50		
17. Vacuum and Inert-Gas tube sign		each transformer	.50		
18. Incandescent Signs, studded lights		per socket	.05		
19. Arc and mercury lamps, spot and floodlights (mogul base)		each	.25		
20. Motors, each horsepower or fraction thereof each motor		H. P.	.15		
21. Generators, rectifiers, transformers, etc		K. W.	.10		
22. Feeders or subfeeders No. 3 B & S gauge or larger		each	1.00		
23. Raceways, wireways, busways, gutters		per ft.	.05		
24. Electric heating devices (other than those listed above)		first kilowatt	.50		
25. Service equipment — 0-100 amps. new or overhauling		per disconnect	1.00		
Service equipment — 100 amps. to 600 amps.		per disconnect	2.00		
Service equipment — over 600 amps.		per disconnect	4.00		
26. Temporary service, etc. (3 month period)			2.00		
27. Motion picture, stereopticon and x-ray machines, etc		each	2.00		
28. Re-inspection after time limit on notice			2.00		
29. Minimum fee for any permit requiring separate inspection		MINIMUM FEE	2.00		
30. Double fee shall be charged for any work started before filing an application for a permit		FEE DOUBLE			
31. Final inspection for permit number			.50		

TOTAL FEES..... 7 10

It is hereby agreed between the undersigned, as owner, his agent or servant and the Village of Fox Point that for and in consideration of the premises and of the permit for the execution of electrical installation, for light, heat or power as above described, to be issued and granted by the Electrical Inspector, that the work thereon will be done in accordance, with the description herein set forth in this statement, and it is further agreed to alter or install same in strict compliance with the Village of Fox Point Elec. Code and to obey any and all lawful orders of the Electrical Inspector of the Village of Fox Point, the Statutes of the State of Wisconsin and the rules and regulations issued by the Industrial Commission of Wisconsin under authority of the State Statutes.

REMARKS: _____

Date for Inspection: June 5/61

Date Approved: _____

Signature: E. Edwards (Supervising Electrician)

Address: 1517 5073rd St

City: West Allis

Zone: 14 Telephone: SP-1-0784

Make check Payable to Treasurer, Village of Fox Point.

WATER PERMIT

Permit No. 768 Application No. 1225 Fox Point, Wis. May 16 1950

Permission is hereby given to do the work necessary to supply with water the premises of W. C. Trinkel described as follows:

Description	Lot	Blk.
<u>Fox Point</u>	<u>3</u>	<u>2</u>

being No. 1015 on the 5 side of Chunckville

The above named is permitted to employ J. [unclear] a Licensed Plumber for the purpose of laying a 1 inch Copper service pipe from Main to Curb: a 1 inch service pipe from curb to building at [unclear]

as per application made subject to the Rules and Regulations of the Village Board and of Ordinance No. 66 of the Village of Fox Point and amendments.

Attorney General 100
Received for Permit \$ Dollars

Received for Fixtures \$ Dollars

Returns must be made on all work done.

[Signature]
.....
WATER INSPECTOR
[Signature]
.....
PERMIT CLERK

License No.

1109 SHEET 2 - VILLAGE'S COPY

Permit No. 5626

Rec # 16916
6/2/61
cst

DEPARTMENT OF ELECTRICAL INSPECTION

Application for Permit for Electrical Installation

VILLAGE OF FOX POINT

TO THE ELECTRICAL INSPECTOR:

Date May 31, 1961

The undersigned hereby applies for a permit for the execution of electrical installation for light, heat, or power, as hereafter prescribed:

Location 1015 East Churchill
(Give exact street and number. Do not give corner)

Elec. Contractor A. C. Frodermann & Bro., Inc. Address 2006 West Center Street

Builder Milwaukee Furnace Company Address 2138 West National Avenue

Owner John S. Coffey Address

What is occupancy of the building NEW OLD Old residence

1. Outlets.....	each	\$.15	
2. Fixtures.....	each10	
3. Fixtures — fluorescent, cold cathode, lumiline, mercury vapor.....	each lamp10	
4. Audible or visual devices.....	per device10	
5. Exhaust and ventilating fans and their control (below 1 H.P.).....	each50	
6. Built-in electric heaters; bathroom, nursery, etc.....	each50	
7. Garbage Disposal.....	each50	
8. Dishwasher.....	each50	
9. Clothes dryer.....	each50	
10. Range or other receptacles over 150 volts.....	each50	
11. Water heater.....	each50	
12. Automatic heating equipment — gas, oil, coal.....	2 each	2.00	4.00
13. Automatic water systems.....	each	1.00	
14. Refrigerating, air conditioning, etc., machines.....	each	2.00	
15. Strip lighting, plug in strip, trol-e-duct, etc.....	per ft.03	
16. Dimmers or Time Clocks.....	each50	
17. Vacuum and Inert-Gas tube sign.....	each transformer50	
18. Incandescent Signs, studded lights.....	per socket05	
19. Arc and mercury lamps, spot and floodlights (mogul base).....	each25	
20. Motors, each horsepower or fraction thereof each motor.....	H. P.15	
21. Generators, rectifiers, transformers, etc.....	K. W.10	
22. Feeders or subfeeders No. 3 B & S gauge or larger.....	each	1.00	
23. Raceways, wireways, busways, gutters.....	per ft.05	
24. Electric heating devices (other than those listed above).....	first kilowatt50	
25. Service equipment — 0-100 amps. new or overhauling.....	per disconnect	1.00	
Service equipment — 100 amps. to 600 amps.....	per disconnect	2.00	
Service equipment — over 600 amps.....	per disconnect	4.00	
26. Temporary service, etc. (3 month period).....		2.00	
27. Motion picture, stereopticon and x-ray machines, etc.....	each	2.00	
28. Re-inspection after time limit on notice.....		2.00	
29. Minimum fee for any permit requiring separate inspection.....	MINIMUM FEE	2.00	
30. Double fee shall be charged for any work started before filing an application for a permit.....	FEES DOUBLE		
31. Final inspection for permit number.....	50	50
TOTAL FEES.....				4 50

It is hereby agreed between the undersigned, as owner, his agent or servant and the Village of Fox Point that for and in consideration of the premises and of the permit for the execution of electrical installation, for light, heat or power as above described, to be issued and granted by the Electrical Inspector, that the work thereon will be done in accordance, with the description herein set forth in this statement, and it is further agreed to alter or install same in strict compliance with the Village of Fox Point Elec. Code and to obey any and all lawful orders of the Electrical Inspector of the Village of Fox Point, the Statutes of the State of Wisconsin and the rules and regulations issued by the Industrial Commission of Wisconsin under authority of the State Statutes.

REMARKS:

Date for Inspection	Date Approved	Signature
		(Supervising Electrician)
Roughing in		Address <u>2006 West Center Street</u>
Temp.		City <u>Milwaukee</u>
Final		Zone <u>6</u> Telephone <u>Fr 4-2940</u>

Make check Payable to Treasurer, Village of Fox Point.

DEPARTMENT OF ELECTRICAL INSPECTION

Application for Permit for Electrical Installation

VILLAGE OF FOX POINT

TO THE ELECTRICAL INSPECTOR

The undersigned hereby applies for a permit for the erection of electrical installation as hereinafter described:

THIS IS FOR ()

(Give exact street and number. Do not give range)

Name of Applicant: [Illegible]

Address: [Illegible]

City: [Illegible]

State: [Illegible]

Occupation: [Illegible]

Trade: [Illegible]

Kind of Work: [Illegible]

Estimated Cost: [Illegible]

Estimated Date of Completion: [Illegible]

Estimated Date of Start: [Illegible]

Estimated Date of Stop: [Illegible]

Estimated Date of Resumption: [Illegible]

Estimated Date of Final Inspection: [Illegible]

Estimated Date of Final Payment: [Illegible]

Estimated Date of Final Receipt: [Illegible]

Estimated Date of Final Certificate: [Illegible]

Estimated Date of Final License: [Illegible]

Estimated Date of Final Permit: [Illegible]

Estimated Date of Final Approval: [Illegible]

Estimated Date of Final Acceptance: [Illegible]

Estimated Date of Final Completion: [Illegible]

Estimated Date of Final Inspection: [Illegible]

Estimated Date of Final Payment: [Illegible]

Estimated Date of Final Receipt: [Illegible]

Estimated Date of Final Certificate: [Illegible]

Estimated Date of Final License: [Illegible]

Estimated Date of Final Permit: [Illegible]

Estimated Date of Final Approval: [Illegible]

Estimated Date of Final Acceptance: [Illegible]

Estimated Date of Final Completion: [Illegible]

Estimated Date of Final Inspection: [Illegible]

Estimated Date of Final Payment: [Illegible]

Estimated Date of Final Receipt: [Illegible]

Estimated Date of Final Certificate: [Illegible]

Estimated Date of Final License: [Illegible]

Estimated Date of Final Permit: [Illegible]

Estimated Date of Final Approval: [Illegible]

Estimated Date of Final Acceptance: [Illegible]

Estimated Date of Final Completion: [Illegible]

Estimated Date of Final Inspection: [Illegible]

Estimated Date of Final Payment: [Illegible]

Estimated Date of Final Receipt: [Illegible]

Estimated Date of Final Certificate: [Illegible]

Estimated Date of Final License: [Illegible]

Estimated Date of Final Permit: [Illegible]



Inspector of Buildings Department

Certificate of Electrical Inspection

To Wis. Elec. Power Co.: Relative to

Premises 1015 E Chocoma

Fox Point

Owner GARY TAX MAN

This is to Certify, that electrical work done under Permit No. 12483 issued by this

DEPARTMENT to KWK Electric is in conformity with the provisions of the Electrical Code of the Village of Fox Point, Milwaukee County, Wisconsin.

INSTALL:

- Service to Temporary Pole Temporary Service and Meter to Building Permanent Service to Building Hot Water Heater Service and Meter Other

Remarks: _____

Dated 8-13-01, 19____

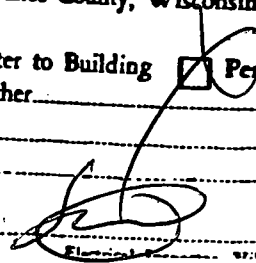

VILLAGE OF FOX POINT

Receipt #: 12439

June 3 1997

Received of : GARY TAXMAN

Amount

and 00/100-----

*****40.00

CATEGORY NUMBER

ACCOUNT NUMBER

AMOUNT

120

R1044460

40.00

CHECK:

40.00

VILLAGE OF FOX POINT

Have a Nice Day
and thank you very much

OFFICIAL RECEIPT WHEN VALIDATED IN THIS BOX
MDP 06/03/1997 1:38 PM *****40.00

VILLAGE OF FOX POINT

Receipt #: 33538

May 18 2000

Received of : TOTAL COMFORT

Amount

Forty and 00/100-----

*****40.00

CATEGORY NUMBER

ACCOUNT NUMBER

AMOUNT

120

R1044450

40.00

CHECK:

40.00

7200 N SANTA MONICA BLVD, TREASURER

Have a Nice Day
and Thank You Very Much

OFFICIAL RECEIPT WHEN VALIDATED IN THIS BOX
MDP 05/18/2000 09:15 AM *****40.00

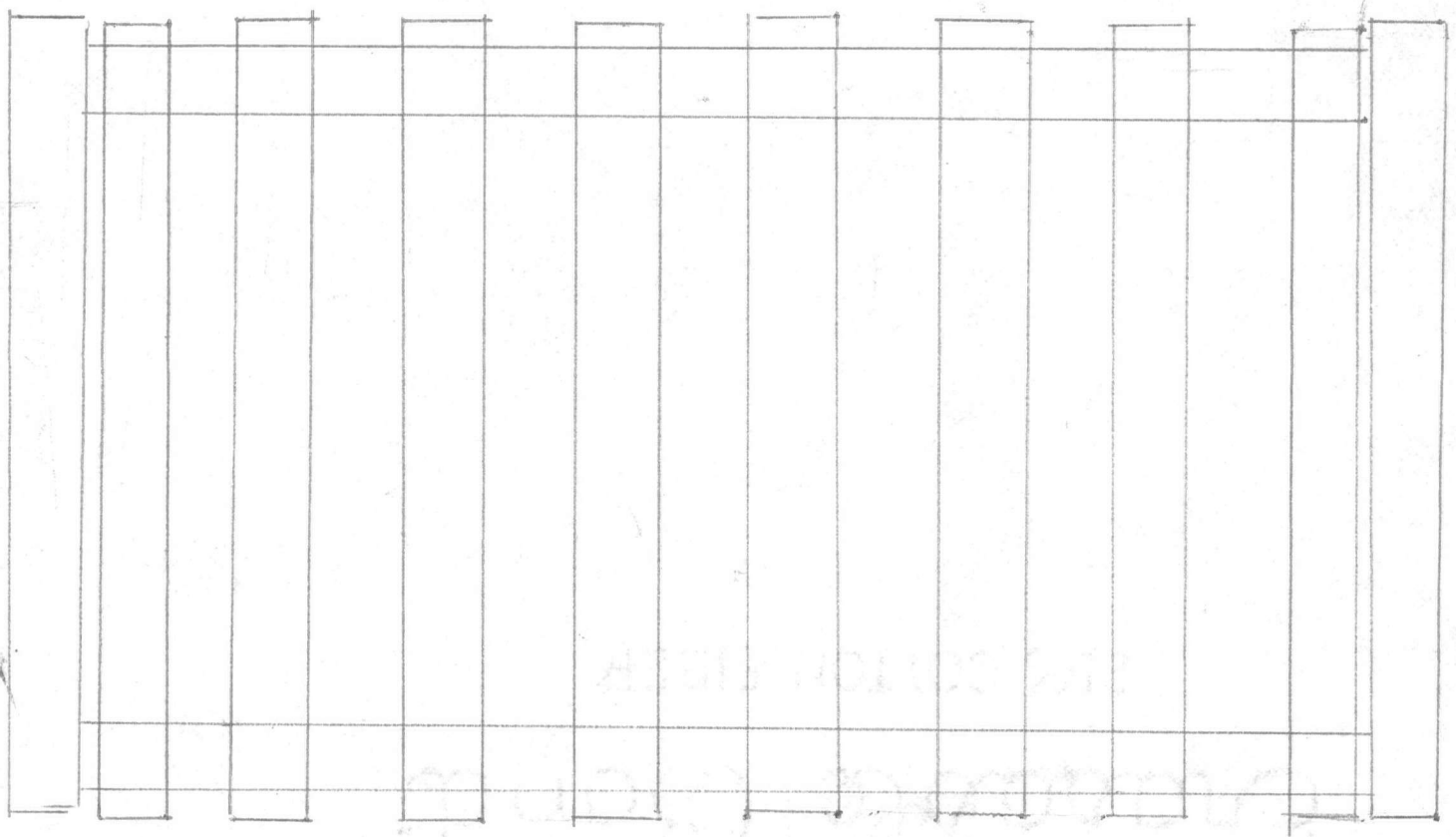

Pine Board on Board Fence
 6' high, 7 foot sections; - 15-1" by 8"
 boards per 7 foot section
 There will be 3-7 foot sections
 on west side of back yard.

Drawing of proposed fence
 for Robert Bukowsky
 1015 E. Churchill Lane, Fox Point
 351-3528

E & F

1109

INSPECTION APPROVAL

Permit 5628

Date 7 Nov 1961

TO DEPT. OF BUILDING INSPECTION
VILLAGE OF FOX POINT

Please be advised that the undersigned has made a FINAL

Electrical Inspection of the residence of John L. Coffey

located at 1015 E. Churchill Lane and hereby approves same.

REMARKS:

Addition approved for occupaney

Installed two new heating plants

Signed

Walter J. Kaiser

WALTER J. KAISER
ELECTRICAL INSPECTOR
VILLAGE OF FOX POINT

1-20-1951

1-20-1951

1-20-1951

TO DIRECTOR, BUREAU OF LAND MANAGEMENT
WASHINGTON, D.C.

RE: [Illegible text]



[Illegible text]

E & F

1109

INSPECTION APPROVAL

Permit 5626

Date 5 June 1961

TO DEPT. OF BUILDING INSPECTION
VILLAGE OF FOX POINT

Please be advised that the undersigned has made a heating plant
Electrical Inspection of the residence of John Coffey
located at 1015 E. Churchill Lane and hereby approves same.

REMARKS:

These are two new heating plants

Signed Walter J. Kaiser
WALTER J. KAISER
ELECTRICAL INSPECTOR
VILLAGE OF FOX POINT

RECEIVED
MAY 19 1961
MAILS OF
BOX 1000
224 25 22

DEPARTMENT OF COMMERCE
BUREAU OF ECONOMIC RESEARCH

MEMORANDUM FOR THE DIRECTOR

Subject: [Illegible]

Reference is made to [Illegible]

The [Illegible] of the [Illegible] of [Illegible]

[Illegible]

21 May 1961
MEMORANDUM FOR THE DIRECTOR
[Illegible]

Ed F

INSPECTION APPROVAL

Permit 5628

Date 5 June 1961

TO DEPT. OF BUILDING INSPECTION
VILLAGE OF FOX POINT

rough in

Please be advised that the undersigned has made a _____

Electrical Inspection of the residence of John L. Coffey

located at 1015 E. Churchill Lane and hereby approves same.

REMARKS:

Signed Walter J. Kaiser

WALTER J. KAISER
ELECTRICAL INSPECTOR
VILLAGE OF FOX POINT

INSPECTOR GENERAL



OFFICE OF BUILDING INSPECTOR
VILLAGE OF FOX POINT

Please be advised that the undersigned has been notified
of the installation of the electrical equipment
located at _____ and hereby approves same.

REMARKS:

VILLAGE OF FOX POINT
ELECTRICAL INSPECTOR
JULY 11, 1961

Signed

Plumber Luke Reuter
 Drainlayer
 Address Thensville Wis

No. 1225

W. E. Reichel
 Owner H. E. Reichel
 Address 1015 E. Churchill St.

Application and Record

Fox Point, Wis., May 16 1950

To the VILLAGE OF FOX POINT, PLUMBING AND WATER INSPECTION DEPARTMENT: The undersigned hereby make application to do the work of Plumbing consisting of

laying a 6 inch Clay drain pipe from Main to Curb
 to lot line to premises at a 1 inch Pipin service pipe from Main to Curb;
 No. 1015 E. Churchill St. building at No. 1015 E. Churchill St.

PERMITS ISSUED

Kind	No.
Sewer and Plumbing	1149
Water	768
Street	760
Meter	773

Remarks: _____

Remarks: _____

the following premises owned by W. E. Reichel 1015 E. Churchill St.
 Name of owner Address

Description	Lot	Block
<u>Fox Point Subdivision</u>	<u>3</u>	<u>2</u>

In the performance of this work the undersigned Plumber or Drain Layer hereby agree to be bounden by and submit to all statutes, city ordinances, and rules and regulations prescribed by the Village Board for the government of Plumbers and House Drain Layers.

License No. 756

Luke Reuter Plumber

FIXTURES WITH DRAIN OR WATER CONNECTIONS

No.	Description	No.
<u>2</u>	Bath Tubs	<u>2</u>
<u>1</u>	Ice Box	<u>3</u>
<u>1</u>	Laundry Tubs	<u>1</u>
<u>1</u>	Sanitary Bubblers	<u>1</u>
<u>1</u>	Sinks	<u>1-80 gal. Hot Water Heater</u>
<u>1</u>	Urinals	<u>1- High Disposer</u>
		<u>1 Disposal</u>

FEES	
<u>Settlement</u>	<u>1.00</u>
Storm Sewer Connection	\$ _____
Sanitary Sewer Connection	<u>6.25</u>
Water Connection	<u>1.00</u>
Fixtures <u>12 @ .50</u>	<u>6.00</u>
Water Meter <u>3/4" Bayne</u>	<u>2.00</u>
Total	<u>16.25</u>
Deposit to cover street repairs	<u>25.00</u>

A 1 inch copper water service pipe was laid in same trench as sewer
 Curb box is located _____ feet of _____ feet of _____

A 6 inch clay sanitary sewer connection was made in main
107.9 feet east of 1st manhole east of manhole at intersection
of Churchill Lane and Linkway

A _____ inch _____ storm sewer connection was made in _____
 _____ feet _____ of manhole _____

Outside Drain	House Drain	Report	Inspection Soil and Under Floor	Report	Final Inspection	Return	Water
				<u>8. Joseph</u>		<u>11/11/51</u>	On
							On
							Off
							Off

Installation Approved W. Reichel 11/11/51 Application Approved W. Reichel 11/11/51
Asphalt Plan Page 4136576 Water and Plumbing Inspector

REMARKS
3/4" Bayne meter
75" trench
30 - 5.00
25 @ .25 = 6.25
Water for cost of clay co. by Olt
Permit 799-2035

COMPLAINT RECORD

meter set 11/11/51
Per No 2391
5/17/50
 SEWER WATER

Owner

Plumber

Permit No. 1225

Street 1015E Churchill

1109

1109

Plumber OTTO KALAL

No. 4841

Drainlayer

Address 10018 W COURTLAND AVE

Tel. No. 461-9228

Application and Record

Owner Mr. Coffey

Address 1015 E CHURCH HILL LANE

Date Oct. - 15, 1973

To the VILLAGE OF FOX POINT, PLUMBING AND WATER INSPECTION DEPARTMENT: The undersigned hereby make application to do the work of plumbing - drainlaying - consisting of

laying a inch laying a inch

drain pipe from Main to Lot line service pipe from Main to Lot line

to Building to Building

at

1015 E CHURCH HILL LANE Fox Point, Wis.
Address at which work is to be done

PERMITS ISSUED	
Kind	No.
Sewer and Plumbing	<u>4681</u>
Water	—
Street	—
Meter	—
Water Usage	—

Subdivision	Lot	Block

In the performance of this work the undersigned Plumber or Drain Layer hereby agrees to be bounden by and submit to all statutes, city ordinances, and rules and regulations prescribed by the Village Board for the government of Plumbers and House Drain Layers.

License No. 3058 Otto J. Kalal Plumber

FIXTURES WITH DRAIN OR WATER CONNECTIONS			
	No.		No.
Hose Bibs		Dishwasher	
Bath Tubs		Wash Basins	
Sump Pump		Water Closets	
Laundry Tubs		Showers	
Sanitary Bubblers		Basement Drains	
Sinks		Garbage Disposal	
Water Heater	<u>1 GAS</u>	Sprinkling System	
Wash Mach. Waste			

FEES	
Water Usage	\$ —
Sanitary Sewer Connection	—
Water Connection	—
Water Heater	—
Fixtures	<u>5.00</u>
Water Meter	—
Total	<u>\$ 5.00</u>
Deposit to cover street repairs	—

Carl H. Plank Permit Clerk

A inch water service pipe was laid in
Curb box is located feet of feet of
..... inch Water Meter No. Date Installed

A inch sanitary sewer connection was made in
..... feet of manhole

A inch storm sewer connection was made in
..... feet of manhole

Outside Sewer	Report	Inside Sewer	Report	Rough In Plumbing Inspection	Report	Final Inspection	Report
						<u>11-28-73</u>	<u>O.K.</u>

Installation Approved 11-28-73 Application Approved 10-15-73, 19.....
As Built Carl H. Plank
Water and Plumbing Inspector

REMARKS

DISCREPANCY RECORD

RECEIVED

OCT 17 1973

Rec # 32046

VILLAGE OF FOX POINT

By W. J. BLONG, Trans.

Owner Coffey

Plumber Otto Kalsal

Permit No. 4041

Street 1015 C. Churchill Lane

APPLICATION FOR BUILDING PERMIT

TO THE BUILDING INSPECTION DEPARTMENT:

The undersigned hereby applies for a permit to build, in accordance with the information tabulated hereafter,

Type of Structure Residence
Residence, Garage, Store, Office, School, Fence, Shed, Sign, Swimming Pool, Etc.

Address 1015 E. Churchill La.

Lot Block

Subdivision

District

Does contemplated structure violate the Village zoning ordinance?.....

Height of Structure.....(stories or feet)

Width (parallel to highway).....(feet) Depth (perpendicular to highway).....(feet)

Distance: Street Line to Front Line of Structure.....(feet)

Distance: Side Lot Line to Structure.....

Type of Construction:..... Exterior finish
Frame, Brick-tile, Etc. Stucco, Siding, Brick Veneer, Etc.

Height of front yard above street grade.....

Number of rooms Baths.....

Estimated cost Garage

Building

Structure 2,000

Is there a private garage?.....

Does the contemplated garage violate the Village zoning ordinance?.....

Size..... Number of stalls.....

Where situated

General construction
Frame — Brick — Stucco — Etc.

Have plans been submitted to the Wisconsin Department of Industry, Labor and Human Relations for examination and approval?

Have plans been approved as being in compliance with all applicable sections of the Wisconsin Administrative code?

Herewith are filed the following duplicate plans..... in number, which I certify I will conform to in the work hereby applied for.

Remarks: Request permit to remove one 550 gal. underground residential heating oil tank per Wis. Adm. Code ICHR 10 regulations

Herewith are filed the specifications that describe the work in question and as shown on plans above submitted.

In making the application the undersigned agrees to obey the Fox Point Building and Zoning Codes pertaining to the erection of all structures and also agrees to obey all other ordinances of the Village of Fox Point.

The undersigned, owner or being duly authorized so to do, hereby gives express authorization to the Village of Fox Point, its officers, agents and employees, to enter upon the premises herein described and fill up any excavation, or tear down, remove or enclose the unfinished structure for which a permit is herein requested in the event of cessation of the building, whenever the Building Inspector shall determine that such premises in the unfinished condition of the structure are dangerous to members of the public, including children, even though trespassers. The undersigned further hereby waives all statutory notices and consents to the determination by the Village Board and the levy and placing upon the tax roll of a special assessment in the amount of the cost to the Village, including customary Village overhead charges incurred in filling up any such excavation or tearing down, removing or enclosing any such unfinished structure.

We hereby agree to provide a house number plate or sign readily observable from the public highway which will be installed not less than 15 days after the structure is occupied.

Owner of Structure Gary Taxman Arch. or Contr. Central Tank Service Inc.

Address 1015 E. Churchill La. Address 1904 S. 71st St.

City Fox Point WI 53217 City West Allis WI 53219
State Zip State Zip

Phone 271-6500 Phone 543-4800

Size of Structure.....(sq. ft.) Permit Fee 25.00 Receipt # 30549 herewith tendered

Date Submitted.....

Date Approved 9/24/92

Date of Permit.....

Signed Greta Olsson on behalf of Central Tank Service Inc.
Architect, Owner, Builder